

Gyptone Access Hatch Guide

The quick easy access hatch for use with Gyptone ceiling boards



The latest Gyptone Access Hatch allows for quick and easy access to above ceiling services and is now fully integrated in the ceiling finish. The upgraded range and increased aperture size makes it more practical for the user, with an aperture of 510mm x 510mm. Remember to leave a minimum of 35mm between the ceiling section and the underside of any services, to allow for removal of the hatch.

Additionally, the Gyptone Access Hatch range is now a gypsum-only construction so no metal parts, the resultant appearance providing a much improved aesthetic finish, allowing it to fully integrate with the corresponding Gyptone board. The hatches themselves consist solely of recyclable materials.

The only requirement being that all edges are painted at the same time as applying the finish to the face on the ceiling panel. Maintenance is just as easy; small areas of damage can easily be repaired by filling and painting.

There are a number of patterns available:

- Gyptone LINE 6 (27501/2)
- Gyptone QUATTRO 41 (27502/9)
- Gyptone QUATTRO 42 (27503/6)
- Gyptone QUATTRO 46 (27521/0)
- Gyptone QUATTRO 47 (27522/7)
- Gyptone SIXTO 63 (27520/3)
- Gyptone BASE (PLAIN) (27566/1)



LINE 6



QUATTRO 41

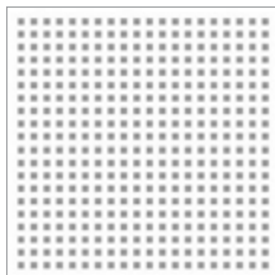

QUATTRO 42

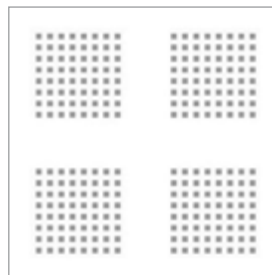

QUATTRO 46

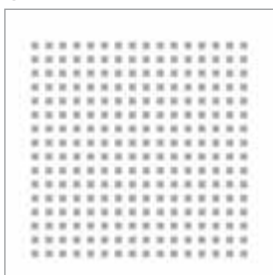

QUATTRO 47

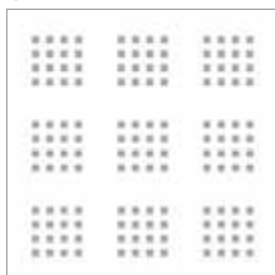

SIXTO 63

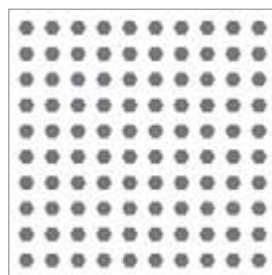

BASE



Key Benefits:

- ◆ Patterns match key Gyptone boards
- ◆ Quick and easy to install
- ◆ Very neat factory cut edges – no site cutting of hatch
- ◆ Access aperture now 510mm x 510mm
- ◆ Jointless frame – seamless finish
- ◆ Euroclass fire rated: A2-s1,d0
- ◆ Safe for use with frequent RH figures of up to 70%
- ◆ Frame and hatch weight: approximately 4.5kg
- ◆ Base provides a plain option when required



Installation:

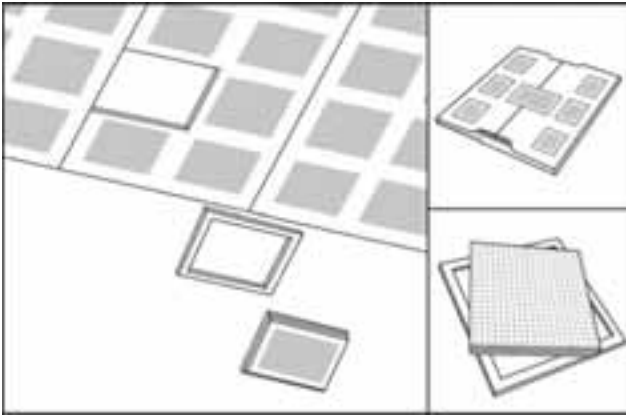

1. Gypstone Access Hatch is used in conjunction with the corresponding board.

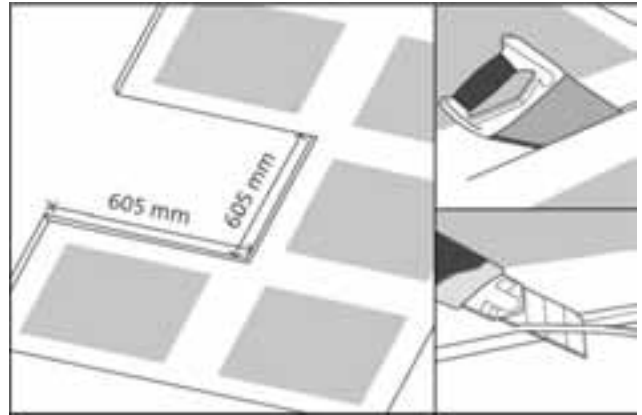

2. The measurements for the cut-out shall be centered round the appropriate perforated area. The hole should be cut out using either a small saw or sharp knife. All edges shall be bevelled to ensure joints can be filled properly.

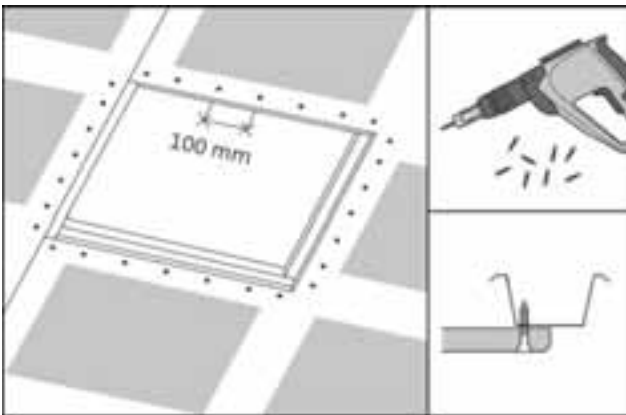

3. Install board onto the Gypframe MF5 Ceiling Section first; MF5 noggings can be installed on two of the edges, ensure screw placement is at 100mm centres. This must be completed on all four edges to ensure all joints are stable and to avoid reflective cracking.

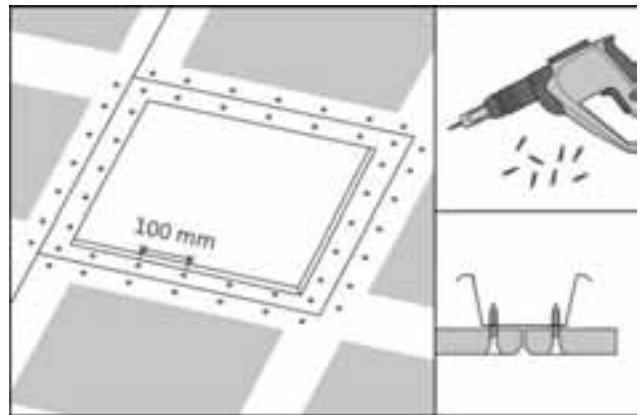

4. Carefully lift the access hatch frame into place and fix on all four edges to the MF5 profiles. Again fixings shall be at 100mm centres.

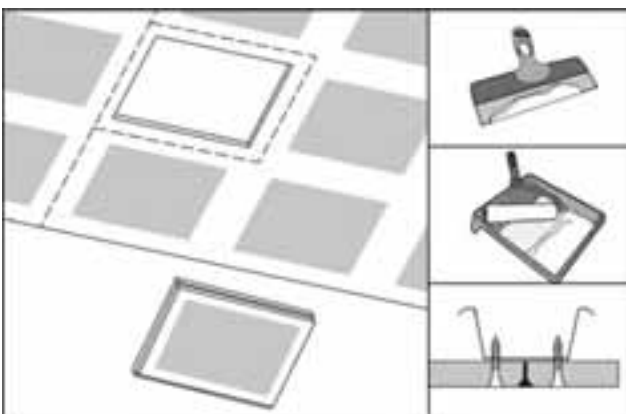

5. Fill the joint between the board and the access hatch frame and once dry, paint. All edges should be painted then allow to thoroughly dry to avoid sticking.

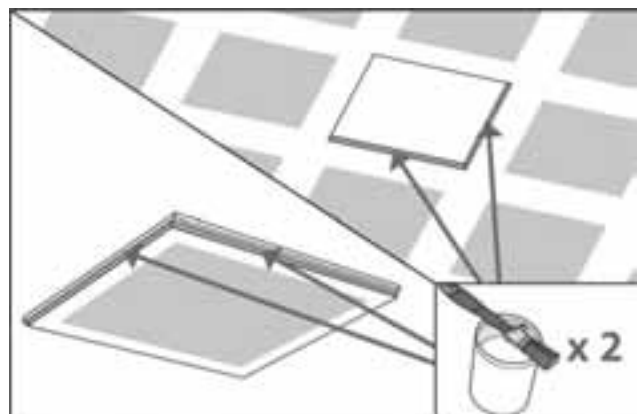

6. The edges of both the frame and the hatch should be painted twice to reinforce them before placing the hatch. We would recommend a high vinyl content water based coating to be used.

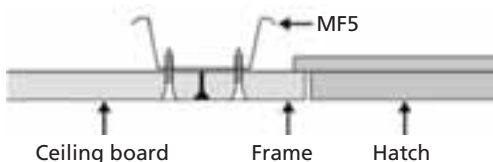

Stacking; on removing the hatch, ensure it is stood with the reverse side in contact with the wall; avoid contact with the finished face.





BRITISH GYPSUM
A BUSINESS SUPERBRAND
SINCE 2008



ASSOCIATION OF
INTERIOR SPECIALISTS

MEMBER

Gyproc, Thistle, Gyproframe and Glasroc are all registered trade names of BPB United Kingdom Limited. Isover is a registered trade name of Saint-Gobain. Proprietor: BPB United Kingdom Limited registered in England 734396, registered office Saint-Gobain House, Binley Business Park, Coventry, CV3 2TT, UK.

British Gypsum reserves the right to revise product specifications without notice. The information in this document was correct to the best of our knowledge at the time of publication. It is the user's responsibility to ensure that it remains current prior to use. The information in this document is for guidance only and should not be read in isolation. Users should read and familiarise themselves with all the information contained in this document and ensure that they are fully conversant with the products and systems being used, before subsequent specification or installation. For a comprehensive and up-to-date library of information visit the British Gypsum website at: www.british-gypsum.com

www.british-gypsum.com

Technical enquiries
British Gypsum
Drywall Academy
East Leake
Loughborough
Leicestershire
LE12 6HX

Telephone: 0844 800 1991
Fax: 0844 561 8816
Email: bgtechnical.enquiries@bpb.com

Training enquiries: 0844 561 8810

British Gypsum May 2012 BG-GAHG-CB-1201



FM 52358

