

Technical Specification

This document provides guidance on how to achieve performance and warranty requirements by exclusively using British Gypsum products or system specifications.

FireCase

D120004 (D) (EN)

One layer of Glasroc F FireCase 30mm providing 60 minutes fire protection to castellated steel beams up to a Section Factor A/V (HP/A) m-1 (max) of 233 at a critical temperature of 450°C. Claims compliant with Yellow Book 5th Edition 20% rule (YB4.2) assessment method.

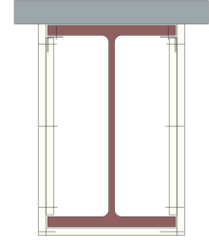

Background

Background	Steel Beam
------------	------------

The maximum permitted steel size which can be encased is 600mm.

Framework

Perimeter framing	Gypframe FEA1 Steel Angle
-------------------	---------------------------

Three sided beam encasement: Fix continuous lengths of steel angle to both sides of the top flange or background using fire resistant fixings at 600mm centres. Alternatively, use shot-fired fixings at the same centres. Ensure face of angle is flush with edge of flange. Fix fascia boards to angles using screws. In single layer linings fit 60mm wide backing strips behind end joints, fixed through fascia boards using screws. Fix fascia boards to soffit boards using screws. Stagger all joints by a minimum of 600mm in adjacent layers and multi-layer linings. Ensure all boards are cut square to maintain tight butt joints with no gaps, and the board-to-board edge fixings going through the vertical fascia board are secured into the centre of the Glasroc F FireCase soffit board.

Board and fixings

Encasement board, Layer 1	Glasroc F FireCase 30mm
Encasement board screws (board to metal), Layer 1	Glasroc F FireCase Screws 40mm
Encasement board screws (board to board), Layer 1	Glasroc F FireCase Screws 70mm

Fix boards on adjacent faces to each other or to metal angles using screws at 150mm centres. Set screw heads flush with board surface.

Finish coat

Finishing is not required to achieve the specified performance, but the system can be finished using either one of our Thistle or ThistlePro plasters, or Gyproc jointing products. See the product range guides on the British Gypsum website for more information.

System performance

Please read performance data with any associated standards.

Fire protection (mins)	60
Maximum section factor (m-1)	233

Standards

These standards relate to the above performance data.

BS EN 13381-9, Test methods for determining the contribution to the fire resistance of structural members: Applied fire protection systems to steel beams with web openings.

Test reports

These test reports relate to the above performance data.

Fire Resistance Test Report WF530529

Further information

SpecSure® system performance warranty confirms that British Gypsum proprietary systems will perform as specified for the lifetime of the building. The **SpecSure®** warranty requires that all components are specified in full and constructed in accordance with British Gypsum's installation guidance. For more details see the British Gypsum website. Always check with the design team before making any changes to the chosen specification, ensuring appropriate substantiation is sought to confirm that the solution still meets all required project performances.