

Technical Specification

This document provides guidance on how to achieve performance and warranty requirements by exclusively using British Gypsum products or system specifications.

GypCeiling Grid

C10A151 (B) (EN)

GypCeiling Grid suspended ceiling system using CasoLine Quick-Lock Grid T24 Tees with a 300mm plenum depth incorporating a Gyptone Line 4 A tile with 75mm Isover Acoustic Slab in plenum.

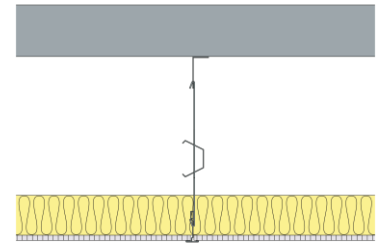

Background

| | |
|-----------------------|----------|
| Structural background | Concrete |
|-----------------------|----------|

Framework

| | | | |
|-------------------|---|-------------------------------|------|
| Soffit connection | Gypframe MF12 Soffit Cleat | | |
| Suspension type | CasoLine Quick-Lock Grid Hangers | Suspension centres - Max (mm) | 1200 |

Suspend ceiling using grid hangers with an appropriate size for the required plenum, secured to soffit cleat via hook. Alternatively, suspension wire (min. 14 swg by others) secured to soffit using fixings recommended by suspended ceiling contractor.

| | |
|-------------------|---|
| Primary framework | CasoLine Quick-Lock Grid Main Tee 24/38 CasoLine Quick-Lock Grid Cross Tee (600) 24/38 CasoLine Quick-Lock Grid Cross Tee (1200) 24/38 |
|-------------------|---|

To achieve a 600 x 600 grid the primary framing should be installed using CasoLine Quick-Lock Grid Main Tee 24/38 at 1200mm centres, CasoLine Quick-Lock Grid Cross Tee (1200) 24/38 at 600mm centres and CasoLine Quick-Lock Grid Cross Tee (600) 24/38 at 1200mm centres. All tees click together.

| | |
|-------------------|---|
| Perimeter framing | CasoLine Quick-Lock Grid Wall Angle WA03 |
|-------------------|---|

Perimeter framing should be suitably fixed to the wall at 300mm centres (maximum 50mm in from a corner). All corners should be mitred.

Insulation

| | |
|---------------------|----------------------------------|
| Insulation, Layer 1 | 75mm Isover Acoustic Slab |
|---------------------|----------------------------------|

Board and fixings

| | |
|----------------------------|-------------------------|
| Ceiling membrane | Gyptone Line 4 A |
| Ceiling board edge profile | A |

System performance

Please read performance data with any associated standards.

| | |
|---|------------|
| Sound absorption class | C |
| Sound absorption coefficient (α_w) | 0.7 |
| Minimum cavity / plenum (mm) | 300 |

| | |
|------------------------------|-------------|
| Maximum cavity / plenum (mm) | 2010 |
|------------------------------|-------------|

Standards

These standards relate to the above performance data.

BS EN ISO 354, Acoustics - Measurement of sound absorption in a reverberation room.

Further information

SpecSure® system performance warranty confirms that British Gypsum proprietary systems will perform as specified for the lifetime of the building. The **SpecSure®** warranty requires that all components are specified in full and constructed in accordance with British Gypsum's installation guidance. For more details see the British Gypsum website. Always check with the design team before making any changes to the chosen specification, ensuring appropriate substantiation is sought to confirm that the solution still meets all required project performances.