

Technical Specification

This document provides guidance on how to achieve performance and warranty requirements by exclusively using British Gypsum products or system specifications.

DriLyner Dab

TL-PIR (A) (EN)

One layer of Gyproc ThermaLine PIR 38mm on Gyproc DriWall Adhesive dabs (10mm nominal cavity) on solid masonry background

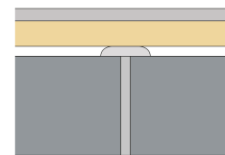

Background

Background	Masonry
Parge coat	Gyproc Soundcoat Plus

If required apply a parge coat at least 6mm thick to the entire surface of the background ensuring all cracked or unfilled joints are covered. Allow to set before following on with plasterboard installation.

Fixing method

Fixing method	Gyproc DriWall Adhesive
---------------	--------------------------------

Apply dabs of adhesive to the background for one board at a time, to achieve at least 20% contact with the surface area of the boards. One row of horizontal dabs to coincide with the top edge of each board. One continuous line of horizontal dabs to coincide with the bottom edge of each board. One row of vertical dabs to coincide with the side edges of each board, and additional vertical row(s) at 600mm maximum centres. Ensure dabs are at least 25mm from board edges.

Before/during installation of dry lining system, fully seal all airpaths around the perimeter of the background and around structural openings and service penetrations through the background using adhesive. Apply as a continuous fillet, leaving no gaps.

Cavity/Offset - Min (mm)	10
--------------------------	----

Board and fixings

Board side 1, Layer 1	Gyproc ThermaLine PIR 38mm
Secondary fixing	British Gypsum Nailable Plugs 80mm

Fix boards to the background using two nailable plugs per laminate, located at mid height 15mm from each of the side edges ensuring plugs penetrate at least 25mm into the background excluding the thickness of any existing plaster finishes. Drive nail heads slightly below the paper surface; do not break paper or gypsum core. For linings to receive ceramic finishes, apply one additional row of dabs at mid-storey height and fix board to the background using nine nailable plugs per board.

Finish coat

The system should be finished using either one of our Thistle or ThistlePro plasters, or Gyproc jointing products. See the product range guides on the British Gypsum website for more information.

Further information

SpecSure® system performance warranty confirms that British Gypsum proprietary systems will perform as specified for the lifetime of the building. The **SpecSure®** warranty requires that all components are specified in full and constructed in accordance with British Gypsum's installation guidance. For more details see the British Gypsum website. Always check with the design team before making any changes to the chosen specification, ensuring appropriate substantiation is sought to confirm that the solution still meets all required project performances.