

Technical Guidance Notes to common issues

GypWall Twin Frame Braced: maximum partition thickness

GypWall Twin Frame Braced is an acoustic separating wall system that can be used between apartments, hotel rooms, hospitals and schools. The system comprises two rows of Gypframe 'C' studs connected by bracing at specified centres using **Gypframe 99 FC 50 Fixing Channel**.

The partition thickness currently published for each system in the **White Book Specification Selector** represents the tested or assessed system configuration and should therefore be regarded as the minimum overall partition thickness.

Increasing the overall partition thickness may provide some benefit in terms of both system sound insulation and system stability. However, at present, British Gypsum does not hold any direct system-based test evidence to confirm improved acoustic performance, beyond that already published.

Accordingly, the published system performance (fire, acoustic, thermal and structural) values remain unchanged when increasing overall partition thickness in line with this guidance (including maintaining the original Isover cavity insulation thickness).

British Gypsum has assessed the strength of increased-length **Gypframe 99 FC 50 Fixing Channels** when used as braces between Gypframe metal stud frameworks. Recent testing and evaluations have enabled the overall partition thickness of a published **GypWall Twin Frame Braced** system to be increased up to a maximum of 600 mm, subject to the following conditions:

- The assessment is based on a deflection limit of $L/240$ at 200 Pa.
- 'L' represents the partition height under a uniformly distributed load of 200 Pa.
- Bracing is formed using Gypframe 99 FC 50 Fixing Channels in accordance with British Gypsum installation guidance.
- The published system performances will remain unchanged when the partition thickness is increased, provided the components and system build-up match the original specification (including maintaining the original Isover cavity insulation thickness).
- Where alternative internal pressures are required, the British Gypsum Technical Support Team should be contacted to undertake project-specific calculations to determine the maximum permitted system height.

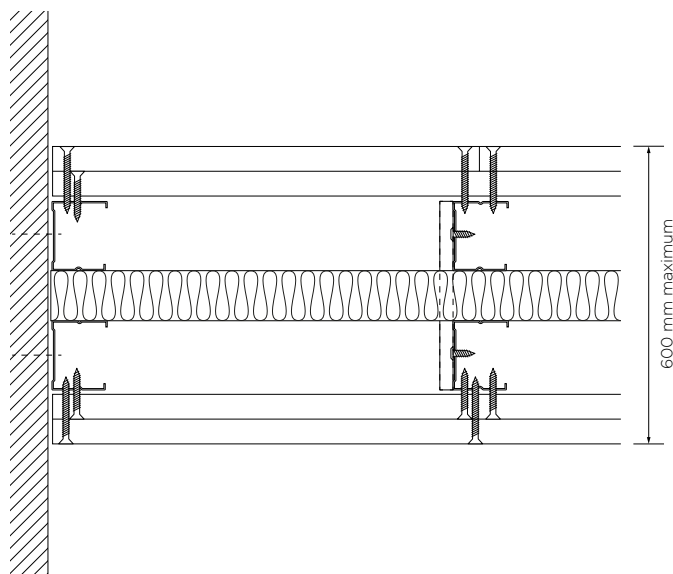

Detail shown is indicative only and does not supersede project-specific design requirements or British Gypsum installation guidance.